

TEOS+ 100RT

1-3kVA

EPO Feature

DSP Control

LCD Display



TOWER / RACK	VFI TYPE	0.9	PLUG & PLAY	ECO FRIENDLY

GENERAL SPECIFICATIONS

- High frequency on-line double conversion technology
- DSP (Digital signal processors) control technology
- Active power factor correction (APFC), input power factor up to 0.99
- Output power factor 0.9
- Wide input voltage range (110 V ~ 300 Vac) and frequency range (40 ~ 70 Hz)
- Auto sensing frequency
- 50/60Hz frequency conversion
- Cold start
- Rear ventilation design and variable speed fan
- Effective software and hardware protection
- Quick and stable charging, 90% capacity restored in 3h (standard model UPS)
- Linear derating in low voltage input reducing battery discharging times

- Settable delayed start when power is restored
- Hot-swappable battery
- Advanced battery management (ABM)
- Multiple functions settable via LCD: output voltage, EOD, autostart, bypass mode, ECO mode and frequency conversion mode
- Multi-platform communications: RS232 (standard), USB / RS485 / SNMP / dry contacts (optional)

AVAILABLE OPTIONS

- Optional USB, RS485 card, AS400 dry contacts, SNMP card, SMS alarms, EPO function, MBS (External maintenance bypass switch)

BACK PANEL

- 1- Overcurrent protection
- 2- AC input
- 3- DC input
- 4- Output
- 5- Fan
- 6- RS232
- 7- EPO
- 8- USB
- 9- Intelligent slot

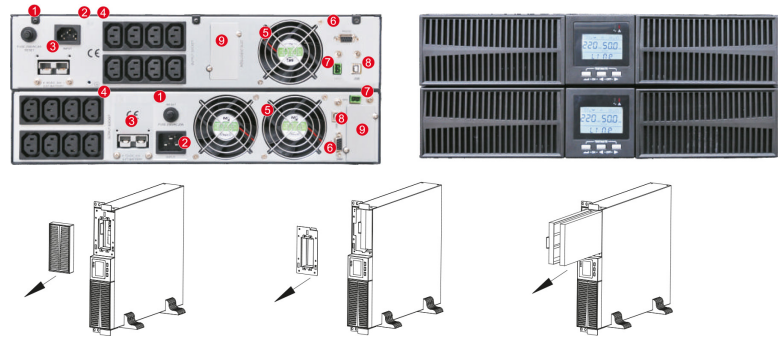

Easy for maintenance, hot-swappable battery

TECHNICAL SPECIFICATIONS

MODEL	Teos+ 101RT	Teos+ 102RT	Teos+ 103RT
Power	1 kVA / 900 W	2 kVA / 1800 W	3 kVA / 2700 W
INPUT			
Rated voltage	208 / 220 / 230 / 240 Vac (settable via LCD)		
Voltage range	110 ~ 176 Vac (linear derating between 50% and 100% load); 176 ~ 280 Vac (no derating); 280 ~ 300 Vac (derating 50%)		
Frequency	40 ~ 70 Hz (auto-sensing)		
Power factor	≥ 0.99		
Bypass voltage range	-25% ~ +15% (settable)		
Total harmonic distortion (THDi)	≤ 6%		
OUTPUT			
Voltage	208 / 220 / 230 / 240 Vac (settable via LCD)		
Voltage regulation	± 1%		
Frequency	45 ~ 55 Hz or 55 ~ 65 Hz (synchronized range); 50 / 60 Hz ± 0.1 Hz (battery mode)		
Waveform	Sinusoidal		
Power factor	0.9		
Total harmonic distortion (THDv)	≤ 2% (linear load); ≤ 5% (non-linear load)		
Crest factor	3:1		
Overload	105% ~ 125% for 1 min, 125% ~ 150% for 30 s, > 150% for 300 ms		
BATTERY			
DC voltage	24V	48V	72V
Inbuilt battery	2x12V/9Ah	4x12V/9Ah	6x12V/9Ah
Charging current (max.)	1A		
Recharge time	90% capacity restored in 3 hours		
SYSTEM			
Efficiency	≥ 90% (Mains mode)	≥ 91% (Mains mode)	≥ 92% (Mains mode)
	≥ 85% (Battery mode)	≥ 86% (Battery mode)	≥ 87% (Battery mode)
	≥ 95% (ECO mode)	≥ 96% (ECO mode)	≥ 97% (ECO mode)
Transfer time	Mains mode to battery mode: 0 ms Inverter mode to bypass mode: 4 ms (typical)		
Protections	Short-circuit, overload, overtemperature, battery discharge protection and fan testing protection		
Communications	RS232 (standard), USB / RS485 / dry contacts / SNMP (optional)		
Display	LCD + LED		
Standards	EN 62040-1, EN 62040-2, EN 61000-3-2, EN 61000-3-3, IEC 61000-4-2, IEC 61000-4-3, IEC 61000-4-4, IEC 61000-4-5, IEC 61000-4-6, IEC 61000-4-8, IEC 61000-4-11, IEC 61000-2-2, IEC 62040-2, IEC 62040-1		
GENERAL			
Operating temperature	0°C ~ 40°C		
Storage temperature	- 25°C ~ 55°C (without battery)		
Relative humidity	0 ~ 95% (non-condensing)		
Altitude	≤ 1000 m, derating 1% for each additional 100 m		
IP rating	IP 20		
Noise level at 1m	≤ 50 dB		
Dimensions (HxWxD) (mm)	88x440x338	88x440x728	
Packaged dimensions (HxWxD) (mm)	201x545x485	201x545x852	
Net weight (kg)	12.3	27.2	30.6
Gross weight (kg)	14.3	31.3	34.0